

Features

- Industry standard “Sixteenth-Brick” footprint
- Up to 25A output current
- High efficiency up to 93.5%
- Low output ripple and noise
- Excellent thermal performance
- Adjustable output voltage(-20%~+10%Vo)
- IUVP, OVP, OTP,OCP, SCP
- Compliance with the EU RoHS directive 2011/65/EU and (EU)2015/863

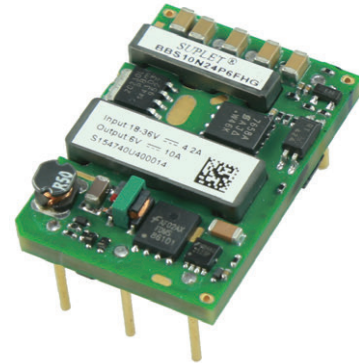

General Specifications

Input Characteristics

Parameter	Specifications
Input voltage <small>Note①</small>	18-36Vdc
	36-75Vdc
	18-75Vdc
Remote Control <small>Note②</small>	Positive(P), Negative(N)

Protection Characteristics

Parameter	Specifications
Input under voltage protection	Yes
Output over voltage protection	Hiccup mode Automatic recovery
Over current protection	Hiccup mode Automatic recovery
Short circuit protection	Hiccup mode Automatic recovery
Over temperature protection	Hiccup mode Automatic recovery

Output Characteristic

Parameter	Specifications
Output power <small>Note①</small>	30-150W
Output voltage <small>Note①</small>	3.3/4/4.2/5/6/12/15/30Vdc
Output voltage precision	±2%Vo
Output voltage trim logic <small>Note②</small>	Positive(P),Negative(N)
Output voltage adjustment range	-20%~+10%Vo
Line regulation	±0.2%
Load regulation	±0.5%
Dynamic response	±5%Vo/200us@25%-50%-75% Io(max.) di/dt=2.5A/μs
Ripple and noise	80mV

General Characteristic

Parameter	Specifications
Efficiency	93.5%(max.)
Operating ambient temperature	-40 C~+85 C
Storage temperature	-55 C~+125 C
Switching Frequency	270-400kHz
Temperature coefficient	200PPM
Isolation voltage	1500Vdc
Isolation resistance	10MΩ (min.)
Safety	Meets IEC60950-1&IEC/UL/EN62368-1
MTBF	12Mhours Telcordia SR-332 Issue4, 2016, 40 C
Packaging	Through-Hole or SMD

Note① Refer to order-information list in the following page for specific values of input and output

Note② Refer to the production naming rules

Order Information

MPN	Input voltage	Output voltage	Output current	Power	Efficiency
BBS2N48P12BTG	36-75Vdc	12Vdc	2A	89%	Sixteenth-Brick
BBS2N48P12BHGA	36-75Vdc	12Vdc	2A	90%	Sixteenth-Brick
BBS2N48P15BHG	36-75Vdc	15Vdc	2A	89%	Sixteenth-Brick
BBS10N48P3V3BTG	36-75Vdc	3.3Vdc	10A	91.5%	Sixteenth-Brick
BBS10N48P3V3CTG	36-75Vdc	3.3Vdc	10A	91.5%	Sixteenth-Brick
BBS10N48P3V3GSG	36-75Vdc	3.3Vdc	10A	91.5%	Sixteenth-Brick
BBS3N24P15FHE	18-36Vdc	15Vdc	3A	88%	Sixteenth-Brick
BBS10N48P5BHGW	18-75Vdc	5Vdc	10A	90%	Sixteenth-Brick
BBS10N48P5GSG	36-75Vdc	5Vdc	10A	90%	Sixteenth-Brick
BBS15N48P3V3BHGW	18-75Vdc	3.3Vdc	15A	90.5%	Sixteenth-Brick
BBS15N48P3V3BTG	36-75Vdc	3.3Vdc	15A	90%	Sixteenth-Brick
BBS15N48P3V3GSG	36-75Vdc	3.3Vdc	15A	90%	Sixteenth-Brick
BBS15N48P3V3GSGW	18-75Vdc	3.3Vdc	15A	90.5%	Sixteenth-Brick
BBS4N48P12BTG	36-75Vdc	12Vdc	4.17A	90%	Sixteenth-Brick
BBS12N48P4V2BHGW	18-75Vdc	4.2Vdc	12.5A	90%	Sixteenth-Brick
BBS10N24P6FHE	18-36Vdc	6Vdc	10A	92.5%	Sixteenth-Brick
BBS12N24P5FHE	18-36Vdc	5Vdc	12A	91.5%	Sixteenth-Brick
BBS12N48P5BTG	36-75Vdc	5Vdc	12A	91%	Sixteenth-Brick
BBS12N48P5FHE	36-75Vdc	5Vdc	12A	89%	Sixteenth-Brick
BBS12P48P5BTG	36-75Vdc	5Vdc	12A	91%	Sixteenth-Brick
BBS5N24P12FHE	18-36Vdc	12Vdc	5A	89%	Sixteenth-Brick
BBS20N24P3V3FHE	18-36Vdc	3.3Vdc	20A	89%	Sixteenth-Brick
BBS17N48P5BHG	36-75Vdc	5Vdc	17A	90%	Sixteenth-Brick
BBS25N48P3V3BHG	36-75Vdc	3.3Vdc	25A	91.5%	Sixteenth-Brick
BBS7N48P12BTG	36-75Vdc	12Vdc	7A	91%	Sixteenth-Brick
BBS17N24P5FHE	18-36Vdc	5Vdc	17A	91.5%	Sixteenth-Brick
BBS3N48P30BHGA	36-75Vdc	30Vdc	3A	93.5%	Sixteenth-Brick
BBS8N24P12FHE	18-36Vdc	12Vdc	8A	89%	Sixteenth-Brick
BBS8N48P12BHGA	36-75Vdc	12Vdc	8.3A	92.5%	Sixteenth-Brick
BBS20N48P5BHGA	36-75Vdc	5Vdc	20A	92%	Sixteenth-Brick
BBS8N48P12CHGA	36-75Vdc	12Vdc	8.3A	92.5%	Sixteenth-Brick
BBS25N48P4V2BHGA	36-75Vdc	4.2Vdc	25A	92%	Sixteenth-Brick
BBS30N48P5BHGA	36-75Vdc	5Vdc	30A	91%	Sixteenth-Brick
BBS30N48P4BHGA	36-75Vdc	4Vdc	30A	92%	Sixteenth-Brick

Outline Diagram (Unit:mm[inch])

Outline diagram (Surface mounting version)

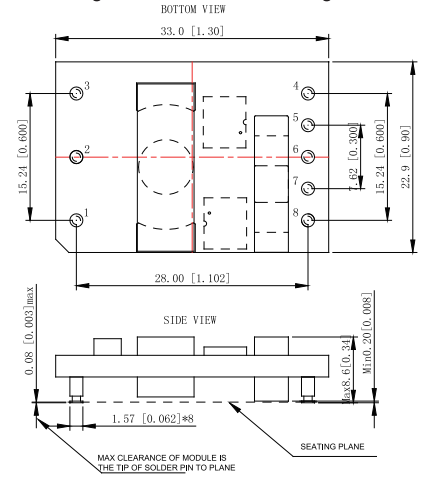

Outline diagram (Through-hole mounting version)

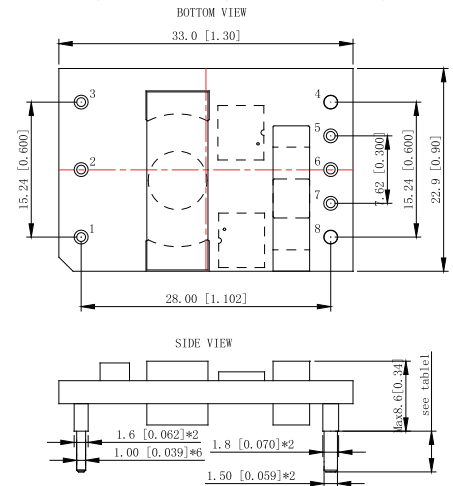

Pin Designations

Pin No.	Symbol	Function
1	+Vin	Positive input voltage
2	REM	Remote control
3	-Vin	Negative input voltage
4	GND	Negative output voltage
5	-SENSE	Negative remote compensation
6	TRIM	Output voltage trim
7	+SENSE	Positive remote compensation
8	Vo1	Positive output voltage

Note: All information contained in this catalog is subject to change without notice, please visit our official website www.suplet.com or contact our sales for the latest information.